



- **Wet lab applications**
- **Trace metal lab applications**
- **Biological (Biotech and Biomedical) and Pharmaceutical applications**
- **Ergonomic Design**



Plastic Concepts Polypropylene Casework

"Leading The Nation in Fabrication"

Plastic Concepts, Inc.'s Polypropylene Casework is constructed of 1/2" and 3/8" thick stress relieved white polypropylene, all seams are fully welded for maximum strength and durability. Polypropylene is an extremely durable and non-corrosive material that cleans easily and does not stain. Polypropylene is a solid surface and maintains its appearance and color. Plastic Concepts, Inc. casework is equipped with quality components; drawer slides, hinges, drawer and door pulls, and latches. All edges are rounded for a safe and corner free work environment. The cabinets can be used individually or in series with other cabinets giving the user the ability to choose from the available styles to create a lab or Clean-room to suit their own needs.

Plastic Concepts, Inc.

**146 Rangeway Rd.
N. Billerica MA
01862**

**Phone: 978-663-7996
Fax: 978-663-7880
Email: info@plastic-concepts.com**

**Visit our website at:
www.plastic-concepts.com**



**Plastic Concepts
Inc.**

Plastic Concepts Polypropylene Casework

This is a sample of our cabinet options. Please visit our website or contact a sales rep for more options

Base Model Codes

WC – Wall Cabinet
 BC – Base Cabinet with Drawer and Door
 BD – Base Cabinet with Door
 BE – Base Cabinet with Drawers
 WS – Wall Shelves
 WP – Wall Pass Thru
 CL – Closet
 OO – Other

Modifiers

SDH – Solid Door Hinged
 # CDH – Clear Door Hinged
 # SDS – Solid Door Slides
 # CDS – Clear Door Slides
 # FS – Fixed Shelves
 # AS – Adjustable Shelves
 # DR – Drawers
 # TT – Tiers
 # PA – Partitions
 # O1 – Other
 # CE – Blind Corner Extensions

Optional Features

- Clear acrylic sliding doors
- Hinged doors
- Two adjustable shelves
- Open shelf units
- Full wall storage cabinets
- Blind corners
- Security cabinets (key lock)
- Peg board back panels
- Internal dividers

Fixtures

- Goosenecks
- Deck and wall mounted gas turrets
- Needle valves
- DI and N2 spray guns
- aspirators

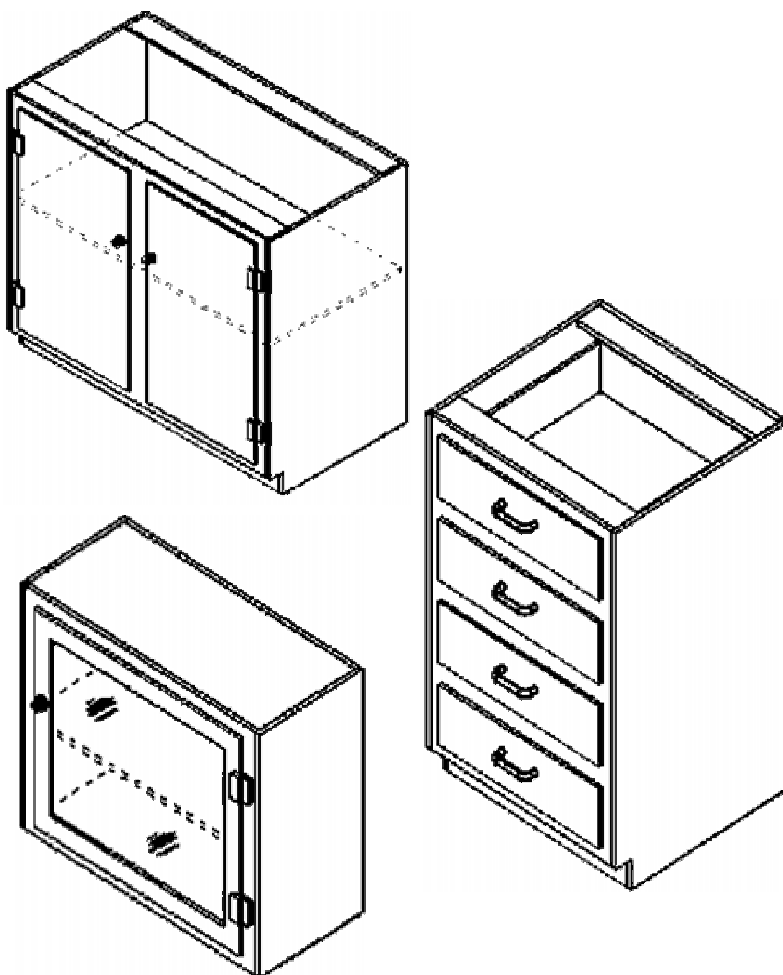

Description	W x H x D
Base Cabinet drawer / door	18" x 30" x 22"
	24" x 30" x 22"
	36" x 30" x 22"
	48" x 30" x 22"
Base cabinet three drawer	18" x 30" x 22"
	24" x 30" x 22"
	36" x 30" x 22"
	48" x 30" x 22"
Base cabinet four drawer	18" x 30" x 22"
	24" x 30" x 22"
	36" x 30" x 22"
	48" x 30" x 22"
Base cabinet acid storage	18" x 30" x 22"
	24" x 30" x 22"
	36" x 30" x 22"
Base cabinet sink unit	18" x 30" x 22"
	24" x 30" x 22"
	36" x 30" x 22"
Base cabinet sink w/ shelf	18" x 30" x 22"
	24" x 30" x 22"
	36" x 30" x 22"
Base cabinet blind corner	48" x 30" x 22"
	55" x 30" x 22"
	65" x 30" x 22"
Base cabinet knee space	18" x 30" x 22"
	24" x 30" x 22"
	36" x 30" x 22"

146 Rangeway Rd.
 N. Billerica MA
 01862

Phone: 978-663-7996
 Fax: 978-663-7880
 Email: info@plastic-concepts.com

Visit our website at:
www.plastic-concepts.com



Plastic Concepts
 Inc.